

(1) Remove handle screw and handle from the 4-function, fill valve

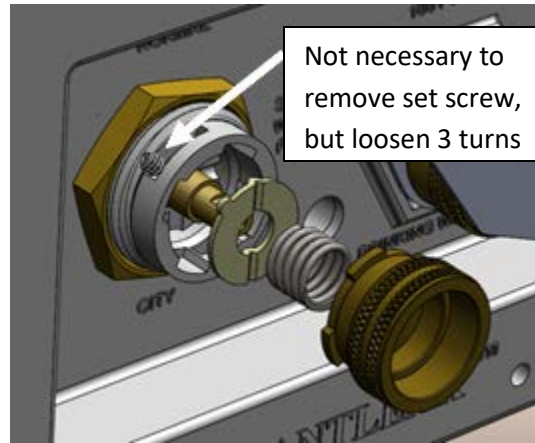

(2) Using supplied 2mm hex key, back off small set screw 3 turns (between "Tank" and "Normal" quadrant of the plastic body) Push-in round knurled cap, and turn counter clockwise (~ 1/8 turn) then pull off cap, and remove spring and "click" washer

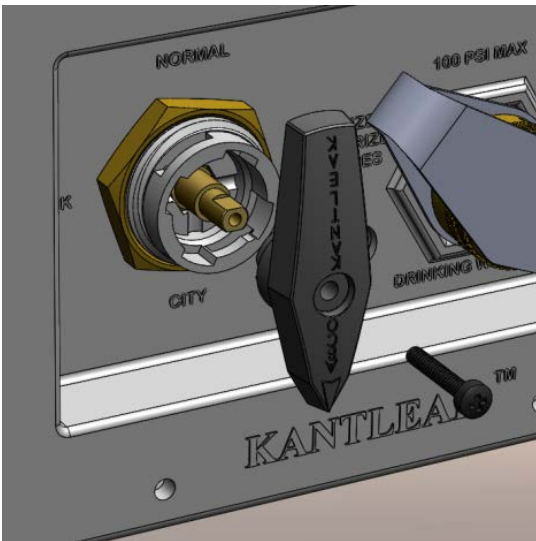

(3) Re-install handle screw and handle back onto the stem of the 4-function, fill valve

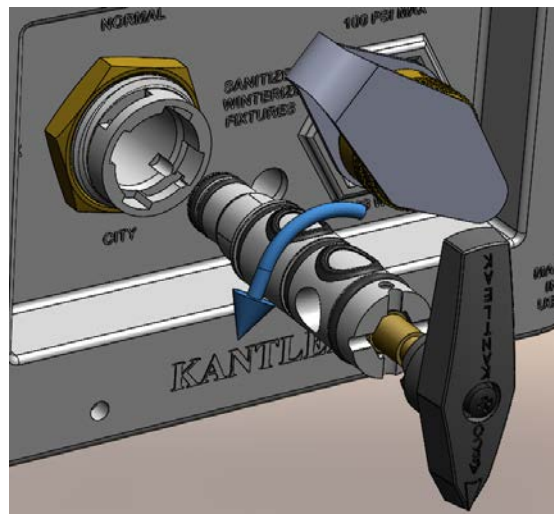

(4) While rotating the handle slowly, pull the valve cartridge out of the valve body. ("click" washer will come out with cartridge if couldn't get out at step 2)

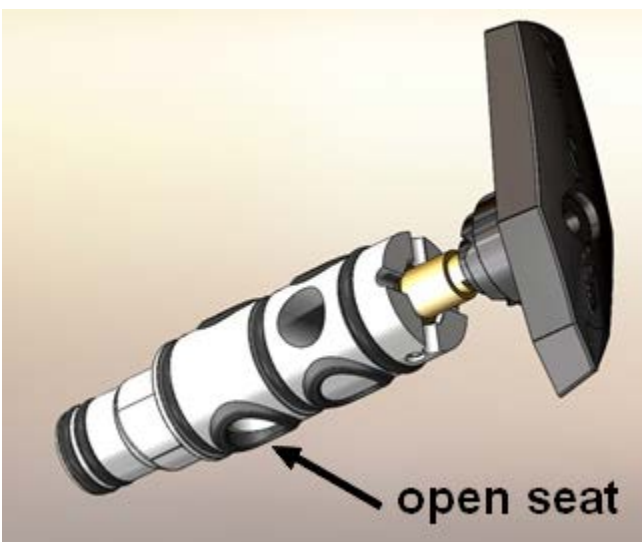

(5) Remove the new, pre-lubed cartridge from packaging, there are 4 rubber seats and 5 o-rings on the cartridge. Remove the handle/screw from old cartridge and move to new cartridge. Make sure the "pointer" of the handle is over the lower seat that has the opening in the center

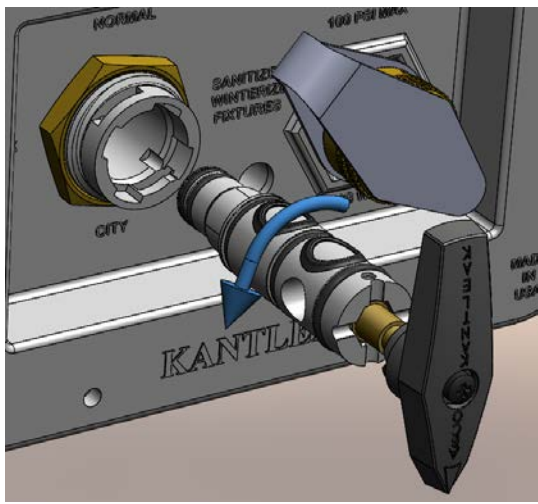

(6) While rotating the handle slowly, push the new valve cartridge into the valve body until fully seated. Stop with the handle pointing to any 1 of the 4 positions

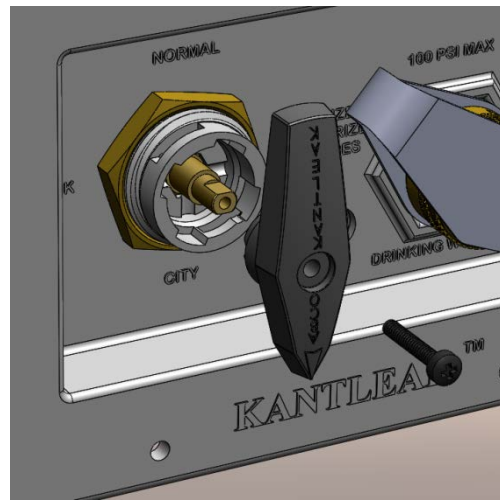

(7) Noting the position the handle is pointing, Remove the handle screw and handle

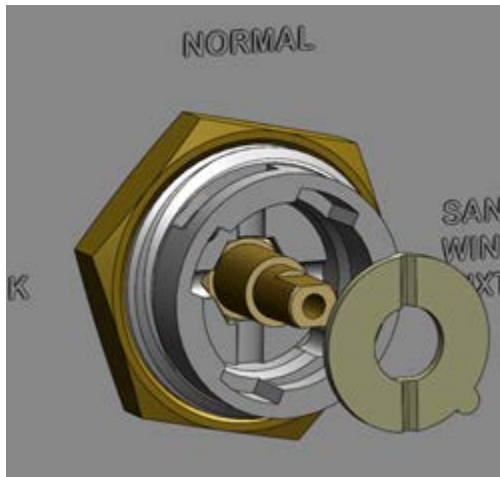

(8) Place "Click" washer, back into valve with the formed, raised side toward the cartridge and the semi-circular locating tab into the internal body groove

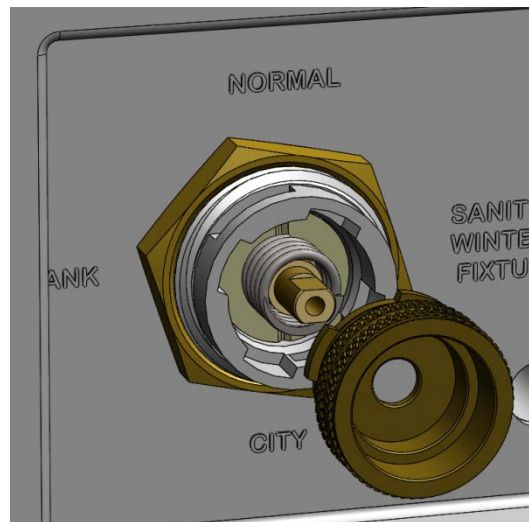

(9) Place spring over valve stem and onto click washer. Align the tabs on the cap, with the slots in the valve body and push onto spring until cap can turn clockwise (approx 1/8 turn) and lock into place.

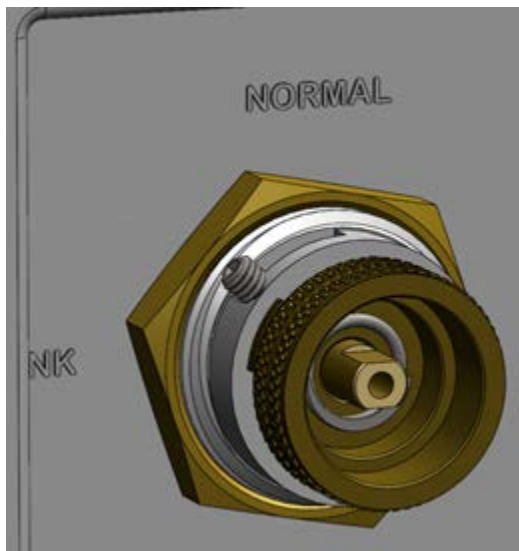

(10) Re-tighten the set screw until snug, flush with plastic (this prevents cap from turning)



(11) Re-install handle with "new sst" screw in the same position as previously removed. Then rotate the handle 2 full turns in both directions, feeling the click in each