

ADDING FUN AND FUNCTION TO EVERY ADVENTURE



2022 PRODUCT CATALOG



**STROMBERG CARLSON
PRODUCTS INC.**

IT PAYS TO BE STROMBERG STRONG.

At Stromberg Carlson, we're celebrating over 60 years of delivering what your customers demand most. Namely, confidence, convenience, durability and value that lasts a long way down the road.

Since 1959, when our grandfather David Stromberg started the business, we've remained committed to a level of quality and innovation that has made us one of the most trusted names in the industry. Which means when you work with us, we're behind you and your business for the long haul.

ARE YOU STROMBERG STRONG?



Lend-A-Hand

- Folds in either direction
- Aluminum rail to resist rust
- Foam grip for easier handling
- Made in the USA

- AM-200* White Finish
- AM-300* Silver Sparkle Finish
- AM-800* Black Finish
- AM-250* White Finish (Mini)
- AM-255* Black Finish (Mini)
- FP-1001-R* Original Foam Grip
- FP-1002-R* Replacement Grip Wrap



Rail Mate

- Maximum support for safe entry/exit
- Easily removable
- Stores during travel
- Lightweight, easy to install
- Large, 38" handle easy to reach and use
- Rail extends 25" from coach for added safety
- Designed for double, triple, quad entry manual steps
- Made in the USA

AP-101* Rail Mate



Soft Touch

- Easy-to-grab, soft-touch handle
- Greater convenience/safety than strap
- Made in the USA

- AH-100* White Handle
- AH-150* Black Handle



Lend-A-Hand Extended Assist Rail

- Designed with same footprint as standard Lend-A-Hand
- Extends additional 10" out and 13.5" down for better user balance
- Self stores outside coach for ready use
- Made in the USA

AM-533* Black Finish

WARNING: Cancer and Reproductive Harm – www.P65Warnings.ca.gov

*While none of our products directly represent a risk of cancer or birth defect, many fasteners and finishes could if oral contact occurs.

LOCKING COMMERCIAL RAILS

HAND RAIL GRIPS

Locking Lend-A-Hand

- Cast mounting blocks
- 1" round stainless steel rail tube
- Railing can swing in either direction
- Rail ships complete with mounting screws
- Backer plate kit available AM-030L (hardware for one complete rail)
- AC-300L and AC-530L have the same footprint as standard and extended Lend-A-Hand rails
- Compatible with Bauer Key'd Alike Program
- For hand grips, see Dura Grip and Zip Grip
- Made in the USA

AM-030L*

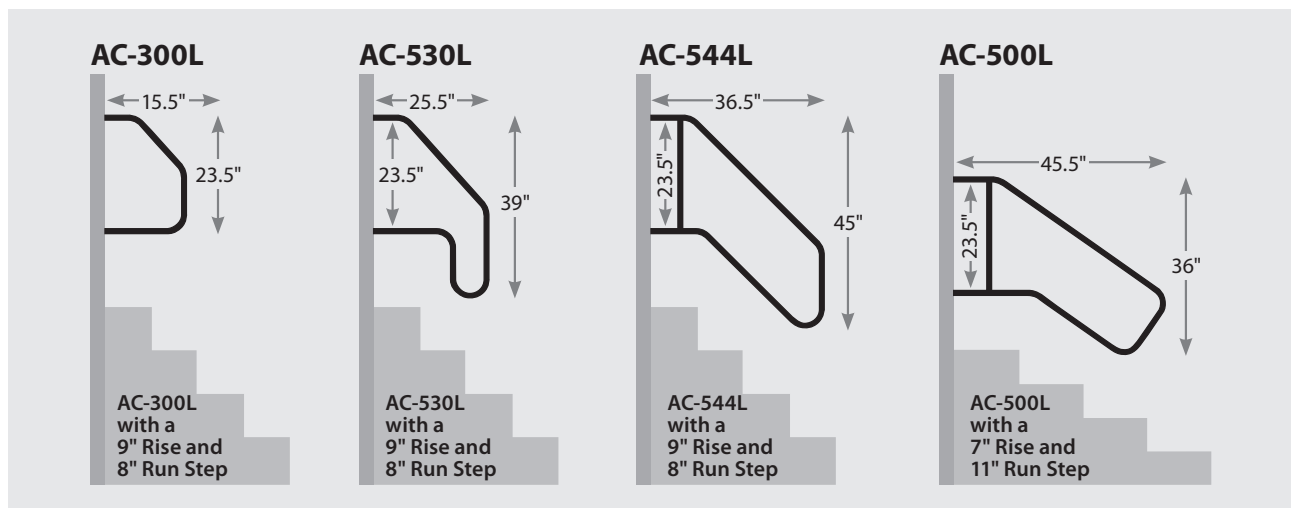

WARNING: Cancer and Reproductive Harm – www.P65Warnings.ca.gov

*While none of our products directly represent a risk of cancer or birth defect, many fasteners and finishes could if oral contact occurs.

Zip Grip

- Keep your hand comfortable and cool with our colorful Zip Grip.
- Made of UV resistant neoprene with a rubber backing material
- 3 colors available, Charcoal, Blue, and Tan to match your coach
- Nylon zipper has a 2 year warranty
- Pockets available for zip ties to secure it to your handle

Other Replacement Hand Rail Grips

- Easy snap and lock installation
- Soft rubber grip for comfort
- Durable and rot resistant
- For 1" D rails
- 2 year warranty
- Made in the USA

AM-01* Dura Grip

WARNING: Cancer and Reproductive Harm – www.P65Warnings.ca.gov

*While none of our products directly represent a risk of cancer or birth defect, many fasteners and finishes could if oral contact occurs.

Base Pad Extreme

For a lifetime of use



- Improves stability of your parked and leveled RV
- 6000 lb capacity, 3500 lb when two are stacked
- Side panel finger hole for ease of carrying and retrieving
- Dimensions: 10" across top, 12" across bottom, 7" tall, or 12-3/8" stacked
- Can be used with 1" or 2" thick Base Pads on soft surfaces – like hot asphalt or sand

- Light weight polycarbonate materials – like bullet proof glass
- 1" shorter than other brands to be used in unlevel conditions at all six points
- No magnets
- Made in the USA

JBP-712.1* Single Pack
 JBP-712.2* 2 Pack
 JBP-712.4* 4 Pack
 JBP-712.6* 6 Pack

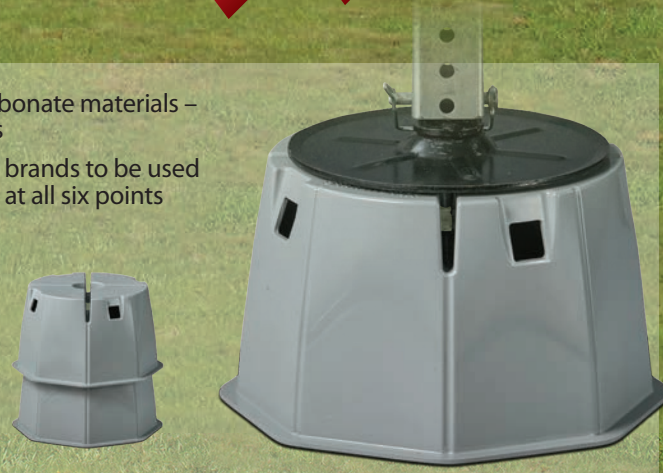

Trucker-Style Wheel Chock



- Tough enough to hold even large motor coach tires in place
- Molded EPDM rubber will not split, shred, crack or break
- Resistant to UV, water, mold and corrosion
- Provides reliable support for your RV – on any surface
- Easy to clean and store
- Made in the USA

JBP-C256* Single Pack



Base Pads Available in 4 sizes



- Can be used on landing gear feet, scissor jack bases and tongue jacks
- Molded EPDM rubber will not split, shred, crack or break
- Resistant to UV, water, mold and corrosion
- Provides reliable support for your RV – on any surface
- Easy to clean and store
- Interlock Base Pads to ramp up to level
- Made in the USA

JBP-69.625* (6"x9"x.625") 4 Pack
 JBP-1011.1* (10"x11"x1") 2 Pack
 JBP-1214.1* (12"x14"x1") 2 Pack
 JBP-1214.2* (12"x14"x2") Single Pack



WARNING: Cancer and Reproductive Harm – www.P65Warnings.ca.gov

Base Pad Shoe



Jack Pads that stay attached!

- Molded EPDM rubber (not crumb rubber)
- 9" Shoe fits Lippert's 4 and 6 point leveling systems
- 9" Shoe fits round footpads made by Lippert, Pac Rim or Venture
- 10" Shoe fits Equalizer Systems round and octagonal 4 and 6 point leveling systems
- Stays attached — no need to store
- Unique bottom increases ground stability — more surface area
- Protects footpads from rocks and roots
- Protects RV pad from rust stains
- Can support a 100,000 lb coach with 4 and 6 point leveling systems
- Ensures a maintenance free future when you add a fresh coat of paint to your footpads prior to installation
- Made in the USA

JBP-S9.1* 9" Single Pack
 JBP-S9.2* 9" 2 Pack
 JBP-S9.4* 9" 4 Pack
 JBP-S9.6* 9" 6 Pack
 JBP-S10.1* 10" Single Pack
 JBP-S10.2* 10" 2 Pack
 JBP-S10.3* 10" 3 Pack
 JBP-S10.4* 10" 4 Pack

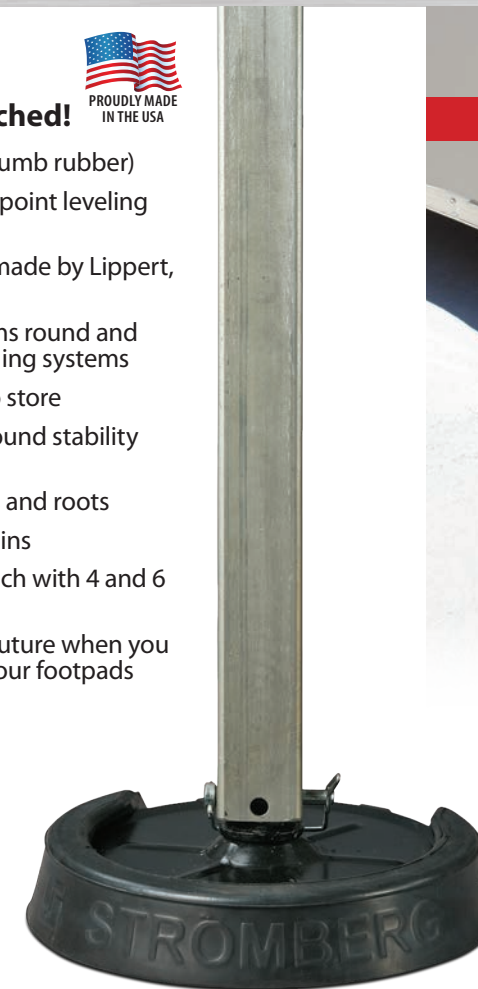

Base Pad Leveler



With Chock and Anti-Slip Mat



- Adds up to 4" lift
- Includes leveler, chock and anti-slip mat
- Light weight polycarbonate material – like bullet proof glass
- Curved edges for easier removal between wheels
- Leveler dimensions: 11-1/2" long, XXX" wide, 4-1/4" tall
- Made in the USA

JBP-C300* Single Pack
 JBP-C302* 2 Pack

WARNING: Cancer and Reproductive Harm – www.P65Warnings.ca.gov

STABILIZE AND LEVEL

T-Chock

FOR TANDEM AXLES



- Pressure against each tire and axle helps your vehicle stay put
- Fits tires spaced 2" to 17" apart
- Rust-resistant coating
- Handle included on all models



EXPANDS FROM 2" TO 17" WIDE

JBP-T217.1* Single Pack

JBP-T217.2* 2 Pack

JBP-T217.W* Replacement Wrench

Base Pad Peak



- Blocks your scissor or stab jacks
- Light weight polycarbonate material
- 4000 lb capacity
- 5" x 8" Stabilizer pad, 10-1/4" x 12-7/8" footprint, 8" tall or 14" stacked
- Made in the USA

JBP-813.1* Single Pack
 JBP-813.2* 2 Pack
 JBP-813.4* 4 Pack
 JBP-813.5* 5 Pack

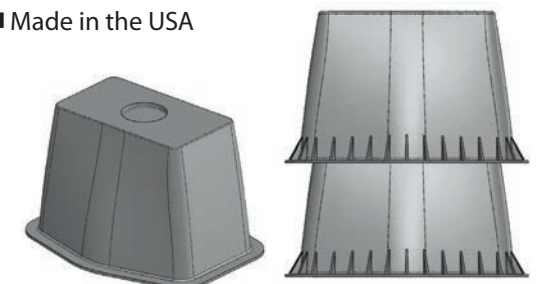

*While none of our products directly represent a risk of cancer or birth defect, many fasteners and finishes could if oral contact occurs.

*While none of our products directly represent a risk of cancer or birth defect, many fasteners and finishes could if oral contact occurs.

WE KNOW JACK. AND THEN SOME.

ELECTRIC TONGUE JACKS

5TH WHEEL LANDING GEAR



Electric Tongue Jacks

- Available in 2500, 3500, 4500 and 5000 lb capacities
- Ball screw mechanism (4500 lb model)
- 18" travel
- 5" drop down foot (3500, 4500, 5000 lb models)

2500 Pound Capacity
JET-2500*

3500 Pound Capacity
JET-3755* Black
JET-3555* White

4500 Pound Capacity
JET-4500*

5000 Pound Capacity
JET-5000*

FEATURES:
BALL SCREW TECHNOLOGY
ON 4500 LB MODEL



Electric Tongue Jack Cover

This cover keeps the weather off of and out of your electric tongue jack while you are parked or traveling. Fits all electric tongue jacks.

JET-01*



ALL BACKED BY A LIMITED TWO-YEAR WARRANTY

The Hitching Post

Keep your trailer connections clean for better performance.

- Plug cover keeps out water, mud and dirt
- Chains snap in easily
- Fits manual or electric jacks
- Mounts on 2" to 2-5/16" jack posts



Scissor Jacks

- Keeps your coach level and stable
- Holds up to 5000 lb
- Bowtie base sits well on hard and soft surfaces

24" SCISSOR JACK

JSC-24*
Pair of jacks & handle
JSC-24-IND*
Single jack only

Expands from 4" to 24" in height

30" SCISSOR JACK

JSC-30*
Pair of jacks & handle
JSC-30-IND*
Single jack only

Expands from 5" to 30" in height
Identical bowtie hole pattern as 24" Scissor Jack



WARNING: Cancer and Reproductive Harm – www.P65Warnings.ca.gov

*While none of our products directly represent a risk of cancer or birth defect, many fasteners and finishes could if oral contact occurs.

LG-179013*
29-1/2" Lead Leg
Drop Leg and Pin



LG-179014*
29-1/2" Follow Leg
Drop Leg and Pin



LG-177202*
33-1/2" Lead Leg
Drop Leg and Pin



LG-177201*
33-1/2" Follow Leg
Drop Leg and Pin



LG-146059*
Lead Leg Repair Kit
Venture only



LG-146060*
Follow Leg Repair Kit
Venture only



LG-142178*
Standard Motor
5500 lb 5500 rpm



LG-196308*
HD Motor
6500 lb
5430 rpm



LG-217884*
Standard Motor and IP Rated Switch**



LG-242728*
HD Motor and IP Rated Switch



LG-145236*
IP Rated Switch



LG-179015*
Aluminum Gear Box



LG-119226*
Manual Crank Handle



LG-119225*
Foot and Pin
(rectangle)



LG-XS*
1"x1" and 3/4" x 3/4"
Telescoping Tubes



LG-Brackets*
Weld-on Brackets
Set of 2



LG-5*
Dual Power Conversion Kit
29-1/2" Leg
5500 lb Motor



LG-6*
Dual Power Conversion Kit
33-1/2" Leg
5500 lb Motor



** Replacement motors and landing gear legs are compatible/interchangeable with both Venture and Lippert landing gear

WARNING: Cancer and Reproductive Harm – www.P65Warnings.ca.gov

*While none of our products directly represent a risk of cancer or birth defect, many fasteners and finishes could if oral contact occurs.

Electric Landing Gear



LG-1* 29-1/2" Leg, 5500 lb Motor
LG-2* 33-1/2" Leg, 5500 lb Motor
LG-3* 29-1/2" Leg, 6500 lb Motor
LG-4* 33-1/2" Leg, 6500 lb Motor

Manual Landing Gear

LG-183708* 29-1/2" Leg



LG-119113*

STEP RIGHT UP. SAFELY.

STEPS AND STOOLS

MANUAL RV STEPS

Platform Steps



Die Cast Aluminum Step

- Platform size 19" x 14"
- Platform height 8-1/8"
- Can be used folded—height 3-1/8"
- Solid foot bottom won't cut rubber non-skid pad
- Step supports 1000 lb

PA-150* Die Cast Aluminum Step

Die Cast Adjustable Aluminum Step

- Platform size 19" x 14"
- Minimum height 7-3/16", maximum height 8-9/16"
- 3 different settings per leg
- Pull to adjust
- Solid foot bottom won't cut rubber non-skid pad
- Step supports 1000 lb

PA-275* Die Cast Adjustable Aluminum Step

Econo Porch



- Interchangeable handrail for left or right hand usage
- 2 and 3 step models available
- Landing platform: 27" wide x 16" deep
- 27" wide x 9" deep steps
- 2 step platform height: 21" (with 7" rise)
- 3 step platform height: 28" (with 7" rise)
- Porch supports 300 lb
- Made in the USA

EHS-102-R*
EHS-103-R*



EHS-103-R



EHS-102-R

Steel Step

- Adjusts to 4" and 8"
- Maximum load 300 lb
- Rubber anti-skid foot

S-150* Steel Platform



Plastic Step



- Adjusts to 4" and 8"
- NOT pet friendly
- Maximum load 500 lb
- Rubber anti-skid foot
- Made in the USA

P-102* Plastic Platform



Manual Steps by Flexco



- Replaces any step on the market
- "Low profile" single steps available
- Extremely sturdy
- Made in the USA



- SMFP-1100* 24" W Single, 7-1/2" Rise
- SMFP-1120* 20" Single, 7-1/2" Rise
- SMFP-1200* 24" Single, 2-3/4" Rise
- SMFP-1220* 20" Single, 2-3/4" Rise
- SMFP-2100* 24" Double, 8" Rise
- SMFP-2120* 20" Double, 8" Rise
- SMFP-3100* 24" Triple, 8" Rise
- SMFP-3200L* 24" Triple, 9-1/2" Rise
- SMFP-4400* 24" Quad, 8" Rise

Jack-In-A-Box

The surprise in this Jack-in-a-Box is that it stabilizes more than 10,000 lb **QUICKLY!**

- Two jacks per carton
- Used to stabilize slide outs
- Removable U-top fits most frames
- All parts are powder-coated or zinc-plated for corrosion resistance
- Adjusts between 20"- 46"
- Easy snap and lock adjustment
- Supports 5000 lb per jack
- Foldable handle for compact storage

JB-246*



Tire Carriers



TR-1 Universal Rigid

TR-2 Universal Folding

The Stromberg Carlson universal tire carrier works great on travel trailers and fifth wheel travel trailers with no welds to break. The formed column is flanged and gusseted to reduce tire vibration. The folding carrier has a built in stop so the tire won't fall when tilted down, giving you access to rear storage.

TR-1* Universal Rigid
TR-2* Universal Folding

WARNING: Cancer and Reproductive Harm – www.P65Warnings.ca.gov

WARNING: Cancer and Reproductive Harm – www.P65Warnings.ca.gov

*While none of our products directly represent a risk of cancer or birth defect, many fasteners and finishes could if oral contact occurs.

*While none of our products directly represent a risk of cancer or birth defect, many fasteners and finishes could if oral contact occurs.

MORE WAYS TO CARRY ON AND CLIMB ABOARD.

RV LADDERS

LADDER REPLACEMENT PARTS



Universal Exterior RV Ladder

- Can go on the rear of any RV – straight or contoured
- Rugged construction
- 250 lb maximum

LA-401* Exterior Ladder Silver
LA-401BA* Exterior Ladder Black

Hinged feature for non-straight/contoured or flat rear walls



Starter Ladders

- 48" starter ladder
 - 250 lb maximum
- LA-148* Starter Ladder Silver



Bunk Ladder

- Provides small feet easier access to beds or larger feet easier access to stored materials
- Rubber tread covers to provide comfort
- Available in multiple lengths and colors
- 250 lb maximum

LA-460* 60" Ladder Silver
LA-466* 66" Ladder Silver
LA-460B* 60" Ladder Black
LA-466B* 66" Ladder Black

Roof Rail

- Universal roof rail adjusts to fit all RVs
 - Seven roof stanchions included
 - Bright anodized finish
- LA-500* Roof Rail Silver

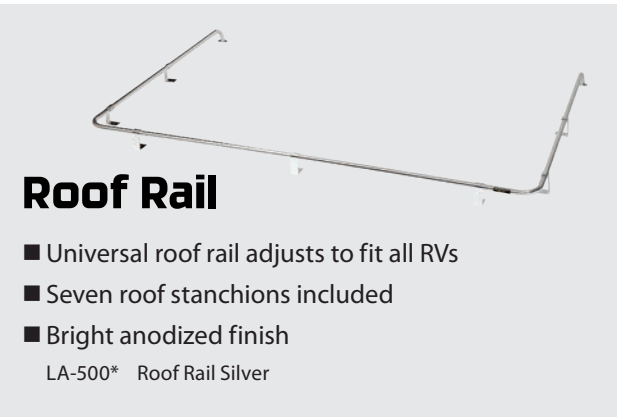

Ladder Chair Rack

- The strap and buckle secure your chairs as you travel
- No rattling
- Made from aluminum
- 50 lb maximum

LA-104* Ladder Chair Rack

Ladder Bike Rack

- No rattling
- Carries up to two bikes
- Made from aluminum
- 50 lb maximum

LA-102* Ladder Bike Rack



RV Bunk Ladder Replacement Parts

1. 2460-A* Hooks for bunk ladders. Both styles in 1 bag
2. 8532-CP* Rubber Feet for Bunk Ladders, 2 per bag
3. 8510-CP* Rubber tread cover for Bunk Ladders, 1 per bag
4. 8539-CP* Push in end cap



Universal Exterior RV Ladder Replacement Parts

1. 8535* 8535-B* (black) Aftermarket Standoff assembly 5" long, rectangular base 1 per bag (Stromberg, Top Line, Surco)
2. 8531* 8531-B* (black) OEM Standoff assembly. Shipped 12" long, trim to length. Round base, 1 per bag (Christianson Industries, Atwood and others)
3. 8521-BK* Roof Mounting Bracket for LA-401 and LA-401BA (black), 1 per bag
4. 8525-BK* Swivel Castings for LA-401 and LA-401BA (black), 1 per bag
5. 8535-CP* (black) U-shaped cradle and bolt for standoff



Replacement Parts for all Stromberg Ladders

- FST-9975* Standoff Nut only Used in the top of bunk ladders and in standoffs, 1 per bag
- 8540-NT* Replacement treads can be installed without disassembling ladder, 1 per bag
- 8540-NTB* (black)
- 8540-CP* Screw-in end cap only, 1 per bag

WARNING: Cancer and Reproductive Harm – www.P65Warnings.ca.gov

WARNING: Cancer and Reproductive Harm – www.P65Warnings.ca.gov

*While none of our products directly represent a risk of cancer or birth defect, many fasteners and finishes could if oral contact occurs.

*While none of our products directly represent a risk of cancer or birth defect, many fasteners and finishes could if oral contact occurs.

WE THOUGHT OF ALMOST EVERYTHING.

OUR EXTENDED PRODUCT LINE

Extend-A-Shower

- Pivots into your shower stall when not needed
- Can be used to drip dry laundry over your shower basin

EXT-3542*
Fits tubs 35"- 42" wide, White Finish

EXT-3542S*
Fits tubs 35"- 42" wide, Satin Finish

EXT-5460C*
Fits tubs 54"- 60" wide, Chrome Finish

54"-60" available in limited finishes and quantities



The Hot Stick

- Non-conductive wooden handle stays cool to the touch and accommodates 2-handed grip
- Rust resistant stainless steel shaft
- 42" long poker to maintain safe distance from fire
- Hooked shaft end to maneuver firewood and stoke embers

FP-42* The Hot Stick



Stake & Grill

- Grill measures 15" wide x 22" long
- Stake measures 36" long
- Adjusts on stake to desired heat
- Upturned edges will keep hot dogs on the grill
- Rotates 360 degrees
- Chrome finish cleans easily
- Nylon bag included to keep neat and tidy

GR-1522*



WARNING: Cancer and Reproductive Harm - www.P65Warnings.ca.gov



Extend-A-Line



- Six independent arms that can carry up to 60 lb of towels, suits and clothes on hangers
- Easily mounts to a 1" or 1-1/2" exterior ladder or can be wall, bumper or A-frame mounted if no ladder is available (with available additional accessories)
- Made in the USA

CL-12* (12" usable line space)
CL-27* (27" usable line space)
CL-36* (39" usable line space)

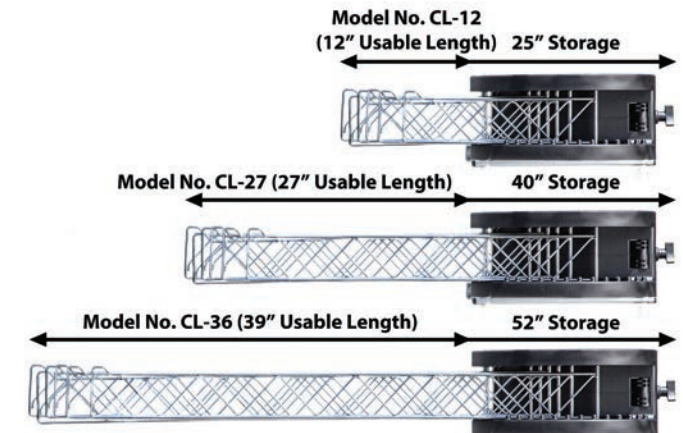

Bumper Mounts

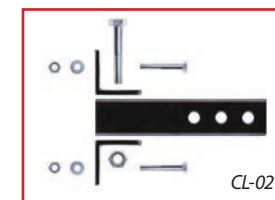

CL-02*
allows CL-01 to be used in a 2" hitch



CL-01*
attached on 4" square bumpers or 2" x 6" A frame

Bumper Mount Clothes Line

- 48" long aluminum uprights
- Can be mounted up to 7' apart
- Strong and durable
- Can be removed for travel without tools

CL-100*
Bumper Mounted Clothes Line



WARNING: Cancer and Reproductive Harm - www.P65Warnings.ca.gov

*While none of our products directly represent a risk of cancer or birth defect, many fasteners and finishes could if oral contact occurs.

*While none of our products directly represent a risk of cancer or birth defect, many fasteners and finishes could if oral contact occurs.

OKAY, WE DID THINK OF EVERYTHING.

CARGO PRODUCTS



Trailer Tray

- Adjusts to fit most A-frame trailers
 - Positioned to provide softest ride
 - Supports up to 300 lb
- CC-255* Trailer Tray

RV Bumper Receiver

- Can be used with most hitch-mounted accessories
- Fits up to 4-3/8" square bumpers
- Provides 2" receiver opening
- Supports up to 200 lb (Refer to bumper rating capacity)
- Heavy steel construction and zinc-plated hardware
- CANNOT be used for towing



BA-100* RV Bumper Receiver

Adjustable Accessory Hitch

- 2" Hitch for Travel Trailers and Fifth Wheels
- Bolts on as Class I or welds on as Class II hitch to frame
- Can mount to side wall of frame or horizontal wall of "C" channel or "I" Beam with angled hardware
- 77" maximum extension to flat wall frame, 80" maximum extension to horizontal surface of "C" channel or "I" Beam
- For use with bike racks, cargo carriers and other accessories
- Not to be used pulling cars or boats in Class 1 configuration

CC-300* Adjustable Accessory Hitch

WARNING: Cancer and Reproductive Harm – www.P65Warnings.ca.gov



Bike Bunk

- Raised receiver on A-frame
- For bike racks with a 2" receiver
- Supports up to 100 lb

CC-275* Bike Bunk



Hose/Cord Caddy



- 17" wide, 6-1/2" tall
 - Holds up to 75' of fresh water hose or 50' of 30 AMP cord
 - Stores hose accessories
 - Each hose end unwinds, bulk of hose remains in caddy
 - Made in the USA
- HC-75* Hose Caddy



Cargo Caddy

- Fits standard 2" receiver
- Inside dimensions 23.3" x 59.7"
- Supports up to 500 lb of evenly loaded cargo
- Powder coated to resist rust

CC-100* Cargo Caddy

CC-125* Cargo Caddy Bike Rack fits up to 2-1/4" tire
Hardware for 2 bikes included

WARNING: Cancer and Reproductive Harm – www.P65Warnings.ca.gov

*While none of our products directly represent a risk of cancer or birth defect, many fasteners and finishes could if oral contact occurs.

*While none of our products directly represent a risk of cancer or birth defect, many fasteners and finishes could if oral contact occurs.

RACK & RIDE.

BIKE CARRIERS

DURABILITY YOU CAN TRUST DOWN THE ROAD.

VENTED TAILGATES



NEW & IMPROVED

Two Bike Carrier

- BC-202BA fits 4" and 4-1/2 square bumpers
- Tilts down for access to vehicle
- Wheel mounts adjust to any size frame
- Weight capacity 80 lb

BC-202BA* Two Bike Carrier (Bumper Accessory Hitch included)
BC-2FT* Fat Tire Adaptor

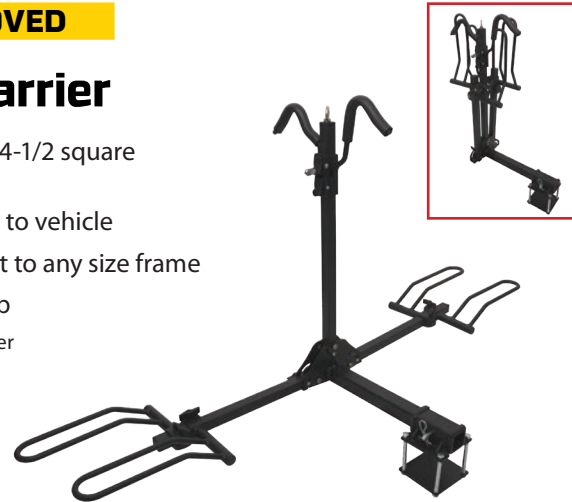

NEW & IMPROVED

Four Bike Carrier

- Fits 2" receiver
- Tilts down for access to vehicle
- Wheel mounts adjust to any size frame
- Weight capacity 160 lb

BC-204* Four Bike Carrier
BC-2FT* Fat Tire Adaptor

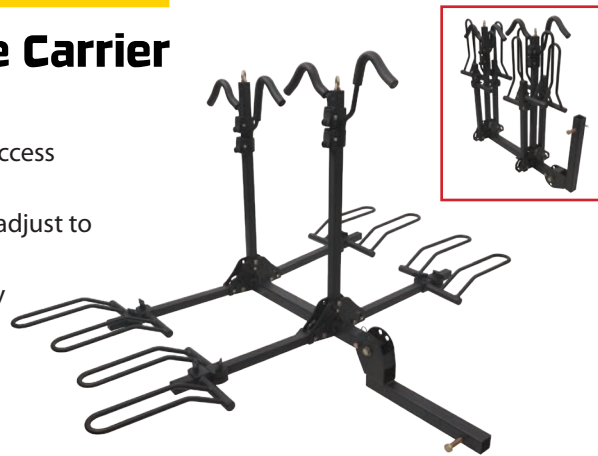

Four Bike Carrier

- BC-108 fits 1-1/4" or 2" receiver
- Tilts down for access to vehicle
- Arms fold down for parking and storage
- Weight capacity 120 lb

BC-108* Four Bike Carrier



Bike Carrier

- Fits 2" receiver
- Tilts down for access to vehicle
- BC-102 Weight capacity 60 lb
- BC-104 Weight capacity 120 lb

BC-102* Two Bike Carrier
BC-104* Four Bike Carrier



WARNING: Cancer and Reproductive Harm – www.P65Warnings.ca.gov



WARNING: Cancer and Reproductive Harm – www.P65Warnings.ca.gov

Visit our website for the most up to date fits

100 Series Gate

Durable steel design, vented to maximize air flow



- Open design improves vision
- Custom fitted
- 100 lb weight limit
- For full size trucks only
- 1 year limited warranty
- Made in the USA



4000 Series Gate

Lightweight, durable glass-filled composite gate with louvers that will never rust.



- Gate improves vision, reduces drag
- Accessory louvers and privacy insert available
- Rotary latches and cables included
- Key locks gate onto truck
- Single-handed release
- 2 year limited warranty
- Made in the USA

	FORD		GM / CHEVY		DODGE		TOYOTA - TUNDRA	
	2020 - 2021 no current fits		2019 - 2021 no current fits		2019 - 2021 no current fits			
150 1500	1987-1996	VG-100*	1988-1998 & 1999-2000 (OB)	VGM-88-100*	1995-2001	VGD-94-101*	2007-2013 & 2014-2020**	VGT-70-4000* VGT-70-100*
	1997-2003 & 2004 (HE)	VG-97-4000* VG-97-100*	1999-2006 (CB)	VGM-99-4000* VGM-99-100*	2002-2008 & 2009*	VGD-02-4000* VGD-02-100*		
	2004* & 2005-2014	VG-04-4000* VG-04-100*	2007-2013	VGM-07-4000* VGM-07-100*	2010-2018	VGD-10-4000* VGD-10-100*		
	2015-2019	VG-15-4000* VG-15-100*	2014-2018	VGM-14-4000* VGM-14-100*				
250 2500	1987-1997	VG-100*	1988-1998 & 1999-2000 (OB)	VGM-88-100*	1995-2002	VGD-94-101*		
	1997-1999 (LD) & 1999-2016	VG-97-4000* VG-97-100*	1999-2007 (CB)	VGM-99-4000* VGM-99-100*	2003-2009	VGD-02-4000* VGD-02-100*		
	2017-2019	VG-15-4000* VG-15-100*	2008-2013	VGM-07-4000* VGM-07-100*	2010-2018	VGD-10-4000* VGD-10-100*		
		2014-2018	VGM-14-4000* VGM-14-100*					
350 3500	1987-1997	VG-100*	1988-1998 & 1999-2000 (OB)	VGM-88-100*	1995-2002	VGD-94-101*		
	1999-2016	VG-97-4000* VG-97-100*	1999-2007 (CB)	VGM-99-4000* VGM-99-100*	2003-2009	VGD-02-4000* VGD-02-100*		
	2017-2019	VG-15-4000* VG-15-100*	2008-2013	VGM-07-4000* VGM-07-100*	2010-2018	VGD-10-4000* VGD-10-100*		
		2014-2018	VGM-14-4000* VGM-14-100*					

(HE) = Heritage Edition
(LD) = Light Duty
(CB) = Classic Body Style
(OB) = Old Body Style
** Functional Fit Only



*While none of our products directly represent a risk of cancer or birth defect, many fasteners and finishes could if oral contact occurs.

*While none of our products directly represent a risk of cancer or birth defect, many fasteners and finishes could if oral contact occurs.

DOING MORE TO GROW YOUR SALES.

DEALER POINT-OF-SALE DISPLAYS

Tongue Jack Display



PRODUCT DISPLAY SIGN

DSP-TJ01* | 30" x 36"
DSP-TJ02* | 30" x 48"

DISPLAY SIGN CLIPS

DSP-SC03*
For a fast and easy installation and an extremely secure hold

DISPLAY SHELF

DSP-TJ04*
Powder coated metal shelf with U-rings to secure product

STROMBERG CARLSON PRODUCTS INC.

LOGO DECAL
DSP-TJ07*
12" x 30"

Product Bill of Material - 4' display shown
(1) JET-2500 (1) KIT-TJ04 (4' display)**
(1) JET-3555 (1) KIT-TJ03 (3' display)**
(1) JET-3755 **Product not included in kit
(1) JET-5000
(6) JET-30

WARNING: Cancer and Reproductive Harm - www.P65Warnings.ca.gov

Lend-A-Hand & Platform Steps



SIGN HEADER
DSP-LH02*
36" x 8"

Product Bill of Material

(3) AM-800 Black	(2) PA-202 Two Step	(1) DISP-AC530L	(2) AH-100 Handle White	(4) AM Foam Wrap
(3) AM-200 White	(1) DSP-SH01 Header	(3) PA-150 Platform Step	(2) AH-150 Handle Black	(3) AM-250 Mini White
(2) AM-300 Silver	(1) DISP-AM Rails	(3) PA-275 Adj Platform Step	(6) AM-01 Dura Grip	(3) AM-255 Mini Black

Sign Header

SIGN HEADER HARDWARE

DSP-SH02*
Clear PVC grips signs securely and are easy to relocate

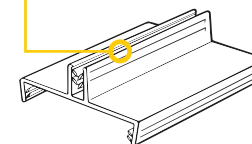

WARNING: Cancer and Reproductive Harm - www.P65Warnings.ca.gov

FRONT



BACK



SIGN HEADER
DSP-SH01*
8" x 36"

*While none of our products directly represent a risk of cancer or birth defect, many fasteners and finishes could if oral contact occurs.

*While none of our products directly represent a risk of cancer or birth defect, many fasteners and finishes could if oral contact occurs.

A SMARTER POINT-OF-SALE SYSTEM

DEALER POINT-OF-SALE DISPLAYS

Stake-And-Grill

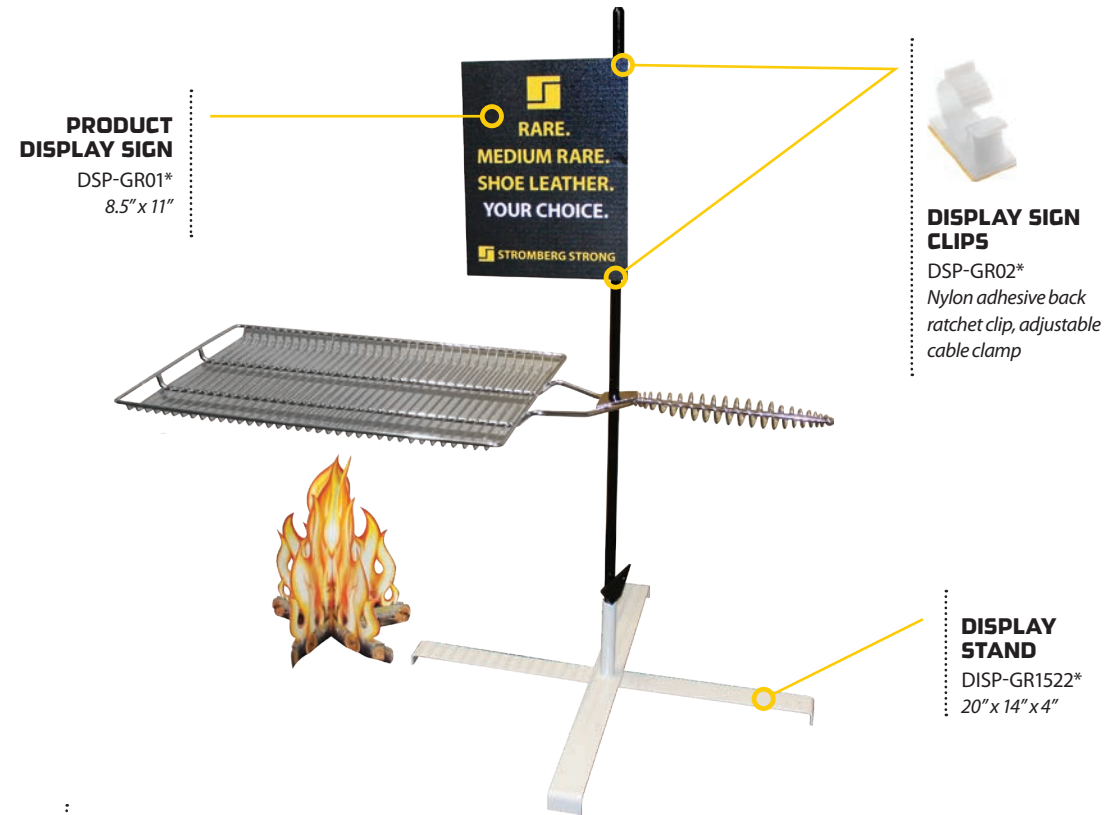

Extend-A-Line

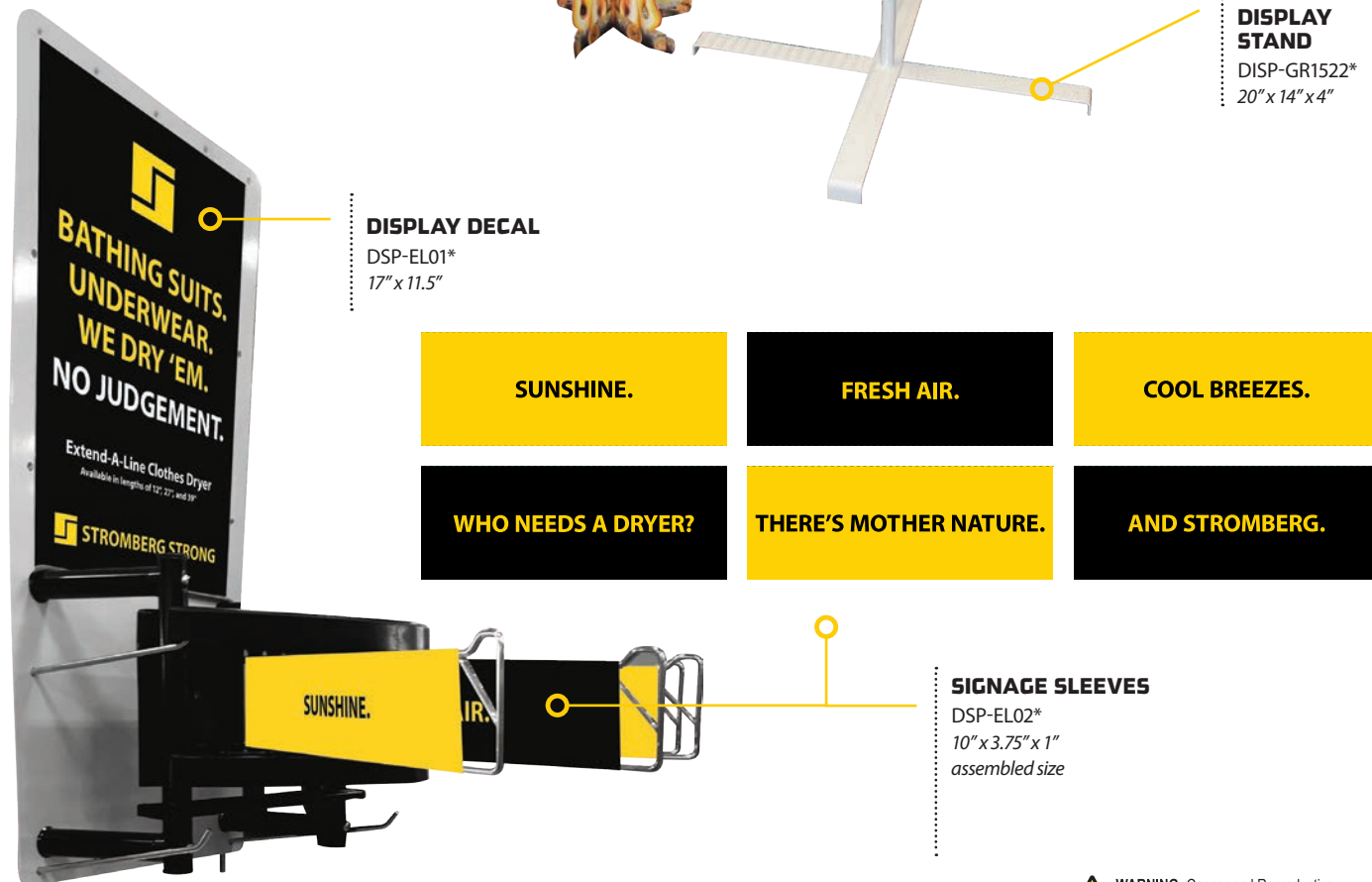

WARNING: Cancer and Reproductive Harm – www.P65Warnings.ca.gov

Hose Caddy Sign



PRODUCT DISPLAY SIGN
DSP-HC1*
36" x 30"

Shelf Talkers



WARNING: Cancer and Reproductive Harm – www.P65Warnings.ca.gov

*While none of our products directly represent a risk of cancer or birth defect, many fasteners and finishes could if oral contact occurs.

*While none of our products directly represent a risk of cancer or birth defect, many fasteners and finishes could if oral contact occurs.

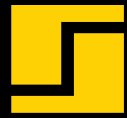

STROMBERG CARLSON PRODUCTS INC.

NEW PRODUCTS

Base Pad Shoe

Jack Pads that stay attached!

- Molded EPDM rubber (not crumb rubber)
- 9" Shoe fits Lippert's 4 and 6 point leveling systems
- 9" Shoe fits round footpads made by Lippert, Pac Rim or Venture
- 10" Shoe fits Equalizer Systems round and octagonal 4 and 6 point leveling systems
- Stays attached — no need to store
- Unique bottom increases ground stability — more surface area
- Protects footpads from rocks and roots
- Protects RV pad from rust stains
- Can support a 100,000 lb coach with 4 and 6 point leveling systems
- Ensures a maintenance free future when you add a fresh coat of paint to your footpads prior to installation
- Made in the USA



JBP-S9.1*	9" Single Pack	JBP-S10.1*	10" Single Pack
JBP-S9.2*	9" 2 Pack	JBP-S10.2*	10" 2 Pack
JBP-S9.4*	9" 4 Pack	JBP-S10.3*	10" 3 Pack
JBP-S9.6*	9" 6 Pack	JBP-S10.4*	10" 4 Pack

T-Chock

For Tandem Axles



EXPANDS FROM
2" TO 17" WIDE

- Pressure against each tire and axle helps your vehicle stay put
- Fits tires spaced 2" to 17" apart
- Rust-resistant coating
- Handle included on all models

JBP-T217.1*	Single Pack
JBP-T217.2*	2 Pack
JBP-T217.W*	Replacement Wrench

Base Pad Leveler

With Chock and Anti-Slip Mat



- Adds up to 4" lift
- Includes leveler, chock and anti-slip mat
- Light weight polycarbonate material – like bullet proof glass
- Curved edges for easier removal between wheels
- Leveler dimensions: 11-1/2" long, XXX" wide, 4-1/4" tall
- Made in the USA



JBP-C300*	Single Pack
JBP-C302*	2 Pack

WARNING: Cancer and Reproductive Harm – www.P65Warnings.ca.gov

Base Pad Peak



- Blocks your scissor or stab jacks
- Light weight polycarbonate material
- 4000 lb capacity
- 5" x 8" Stabilizer pad, 10-1/4" x 12-7/8" footprint, 8" tall or 14" stacked
- Made in the USA

JBP-813.1*	Single Pack
JBP-813.2*	2 Pack
JBP-813.4*	4 Pack
JBP-813.5*	5 Pack

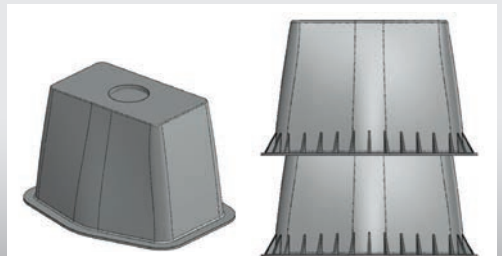

*While none of our products directly represent a risk of cancer or birth defect, many fasteners and finishes could if oral contact occurs.

2022 PRODUCT CATALOG

WWW.STROMBERGCARLSON.COM

